

PRODUCT INFO

FORK-PACK PLUS

Waterproof fork bag with roll closure

QLS system

IP 64

PS36C

PVC free

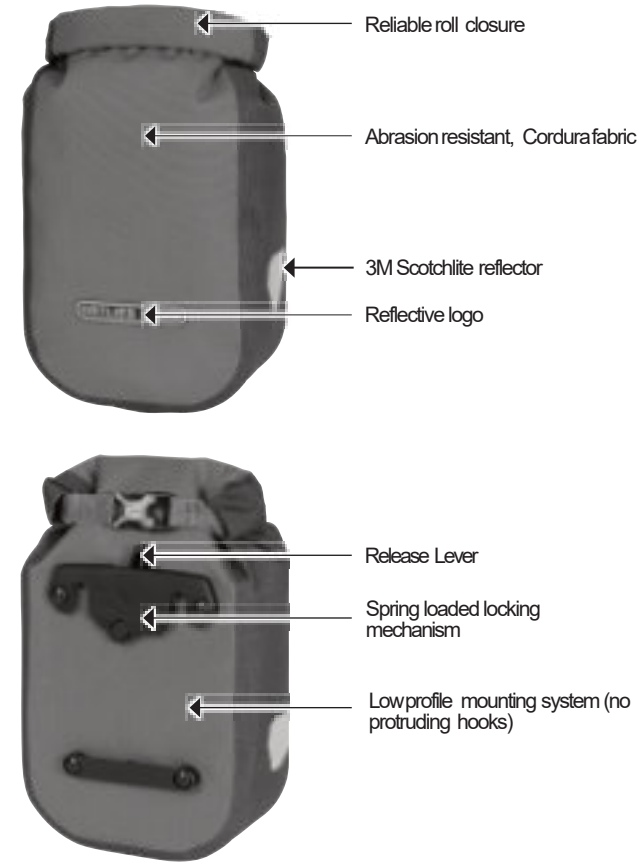

Quick-Lock S adapter plate incl. mounting accessories (included in delivery)



height cm/in.	width cm/in.	depth cm/in.	vol L/cu.in.	weight g/oz.	max. load kg/ lbs
30,5/12.0	19,5/7.7	13/5.1	5,8/350	325/11.5 (adapterincluded)	3/6.6

SPECIFICATIONS:

- + Ultralight, waterproof bag (single pocket) with roll closure
- + TheFork-Packis primarily designed for attachment to bicycle forks, but it can be mounted on non-tapered vertical tubes with a consistent diameter, e.g. Kick Style Scooters
- + Abrasion-resistant, Cordurafabric
- + Allows additional luggage to be carried on bikes using the Quick-Lock S (QLS) adapter system
- + Adapter is compatible with forks with eyelets and tubes with constant diameter from 30 mm to 42 mm
- + TheQuick LockS mounting bracket may be bolted directly to a forks with „brazed-on“ eyelets or attached to vertical tubes using the supplied band-clamps. for carbon forks, only direct mounting is possible
- + Thethree mounting points of the QL-Sadapter follow the industry standard for fork eyelets and are approx. 64mm apart.
- + Ultra fast installation, with one click the bag snaps in to place
- + Theremoval is just as fast, simply movethe release lever and pull the bag upwards
- + Therobust Quick-Lock S mounting plate remains mounted to the bicycle
- + Lowprofile locking elements ensure snag free use
- + Internal stiffener
- + Reflective ORTLIEBlogo
- + Maximumload 3 kg / 6.6 lbs.

Contents: Fork-Pack(240g/8.5oz) with QLSadapter plate (85g/3.0oz), mounting accessories,hardwareand instructions

Optional accessories: QLSMounting-SetFork-Pack(Art. E235) e.g. for use on a second bike; Fork-PackAdapter 45° to 30° (No. E240) for adjusting the mounting angle of the QLSbracket on specific bicycle front forks

Attention:

- + Not suitable for mounting to carbon forks without „brazed-on“ eyelets, tapered fork blades or frame tubes
- + If the product is completely submerged,water can penetrate through the closure

Note: In order to meet standard IP64 (6=dustproof, 4=protected against splash water coming from all directions) the roll closure must be rolled at least 3-4 times. Once submerged, the bag is not waterproof.



FORK-PACK

ORTLIEB WATERPROOF

- DE MONTAGEANWEISUNG
- GB ASSEMBLY INSTRUCTIONS
- FR INSTRUCTIONS DE MONTAGE
- IT ISTRUZIONI DI MONTAGGIO
- NL MONTAGE HANDLEIDING
- DK MONTERINGSVEJLEDNING
- ES INSTRUCCIONES DE MONTAJE
- SE MONTERINGSANVISNING
- NO MONTERINGSANVISNING
- FI ASENNUSOHJEET
- PL INSTRUKCJA MONTAŻU
- JP 装着方法



INHALT:
CONTENTS:
CONTENUTO:
INHOUD:
INDHOLD:
CONTENIDO:
INNEHÅLL:
INNHOUD:
SISÄLLYS:
ZAWARTOSC:
内容物:

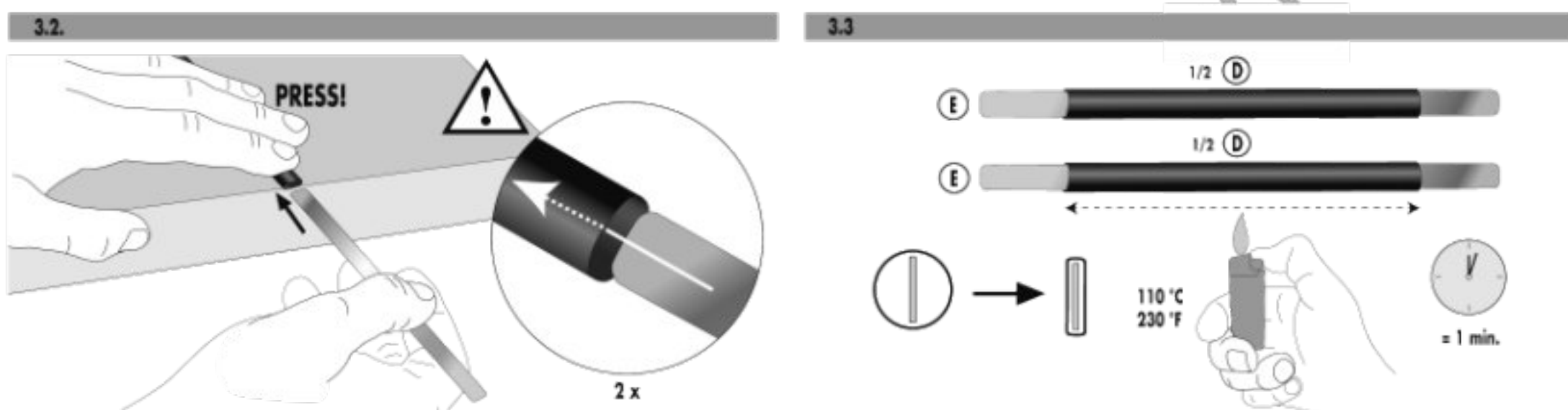
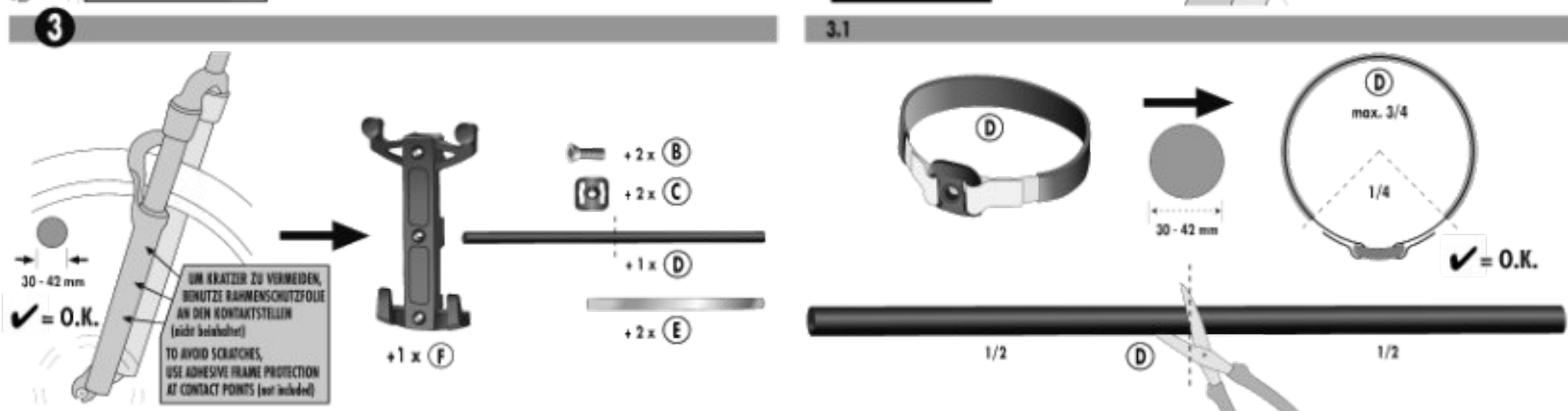
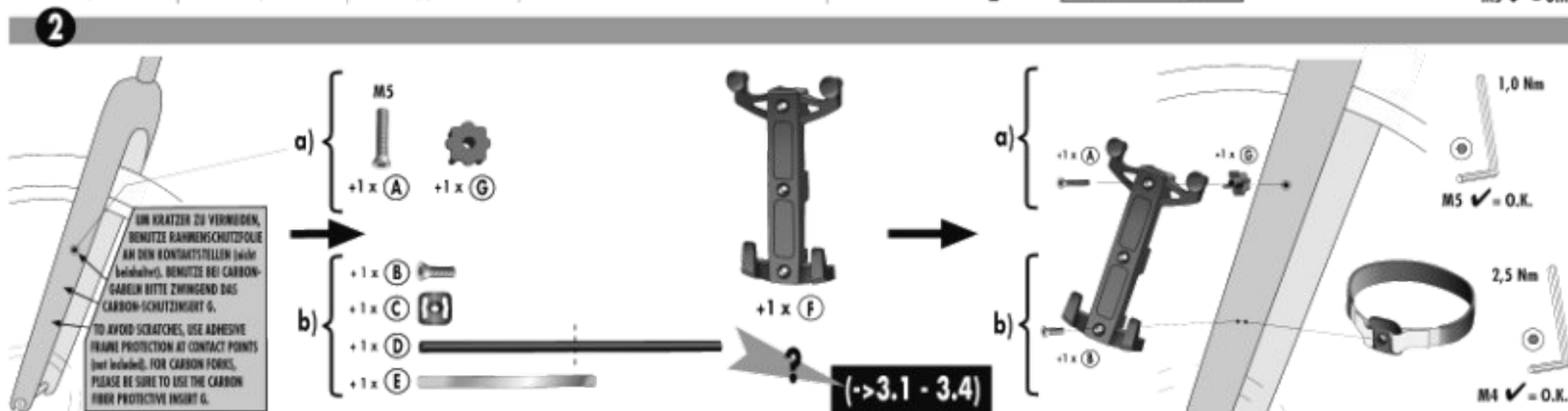
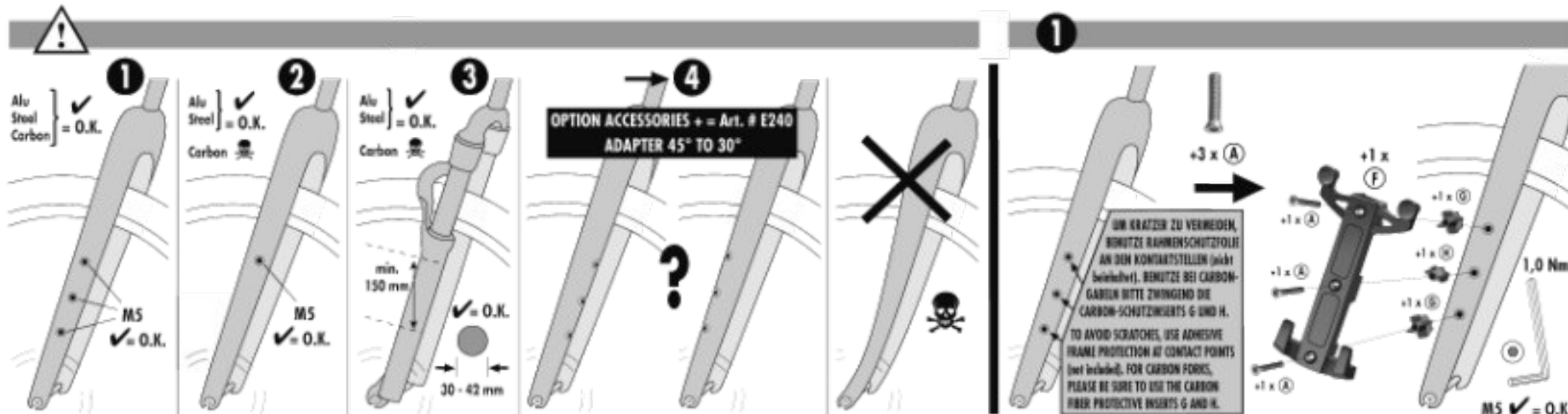
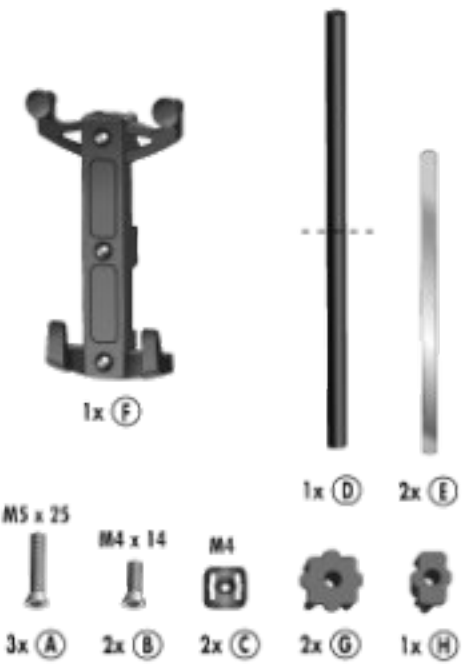

3.4.

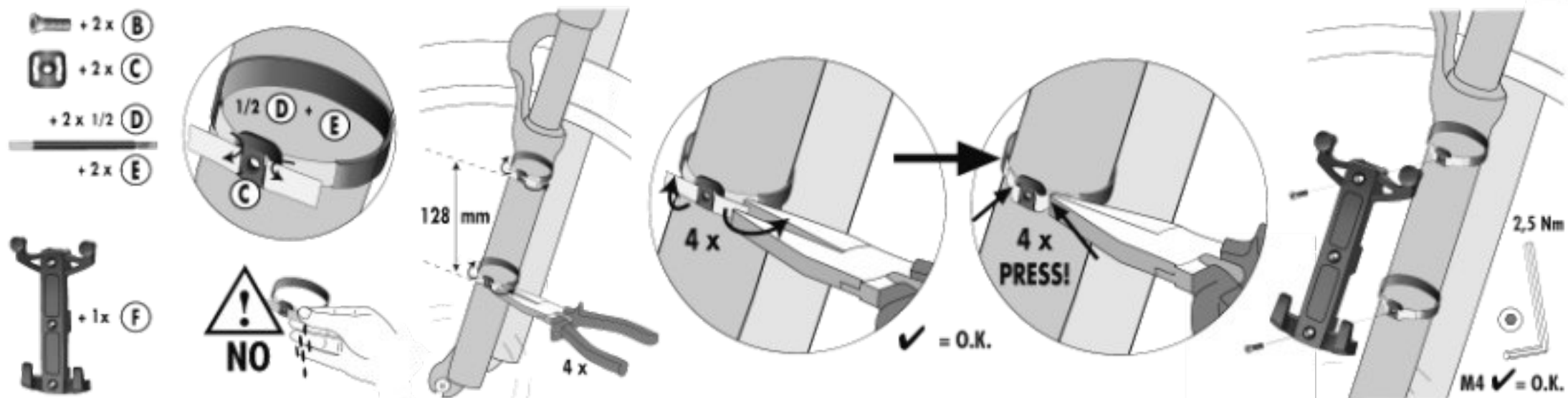

4. CLOSE



5. FIX

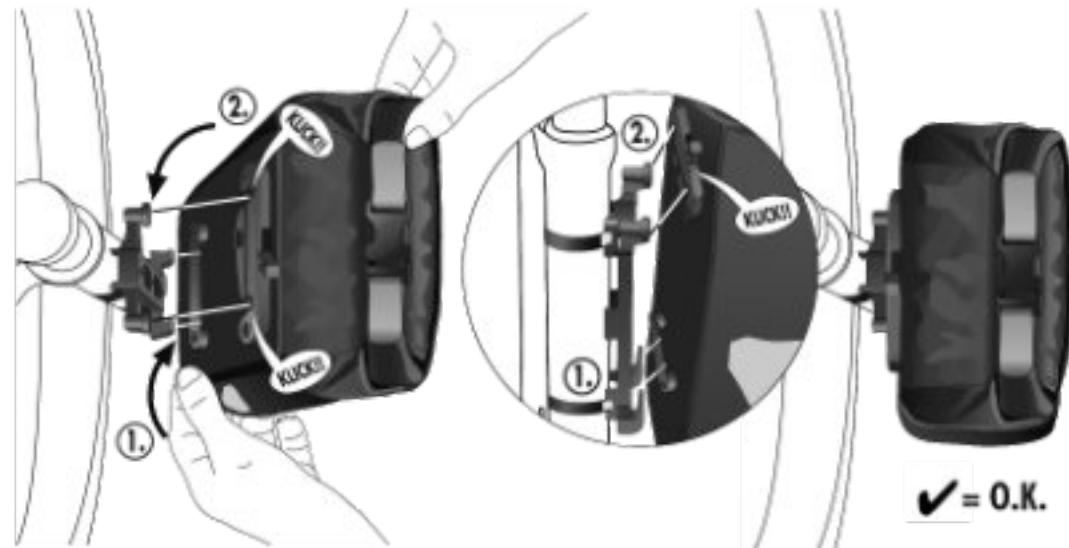

6. UNFIX

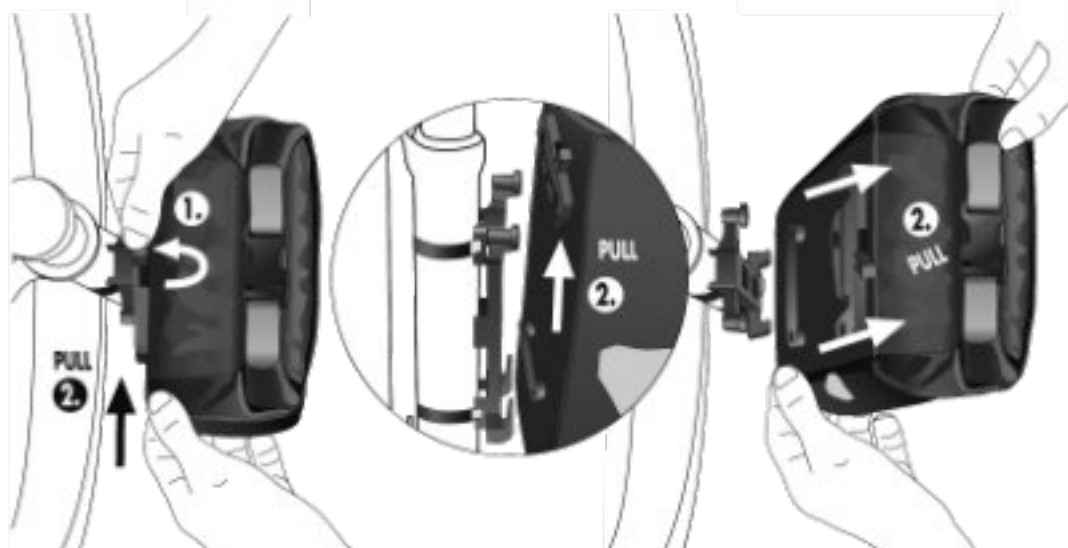

7.

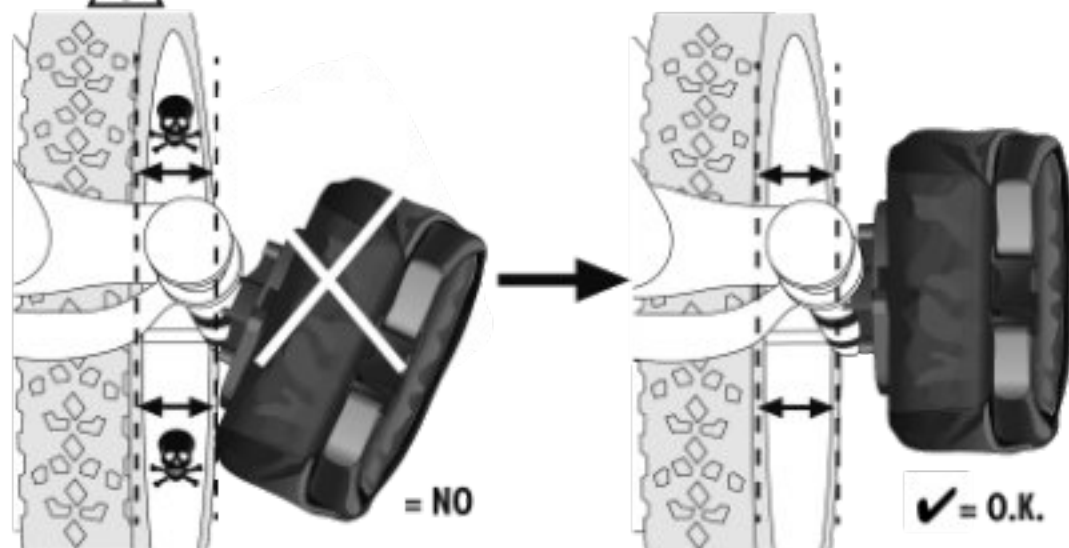

8. ! CHECK FIXATION BEFORE EVERY RIDE!

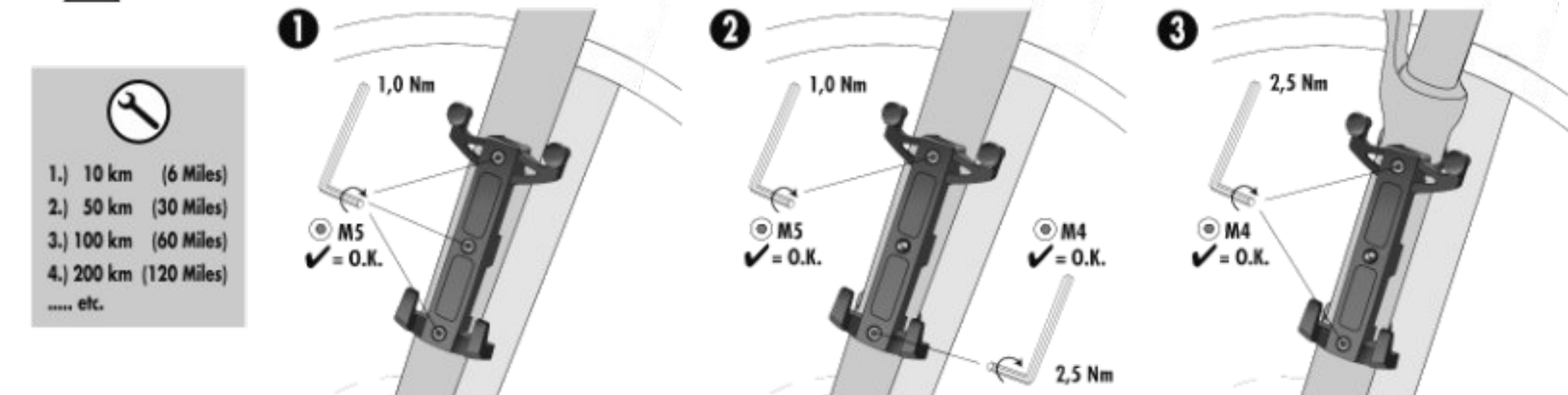

9.

ACCESSORIES



4 OPTION ACCESSORIES += Art. # E240 - ADAPTER 45° TO 30°

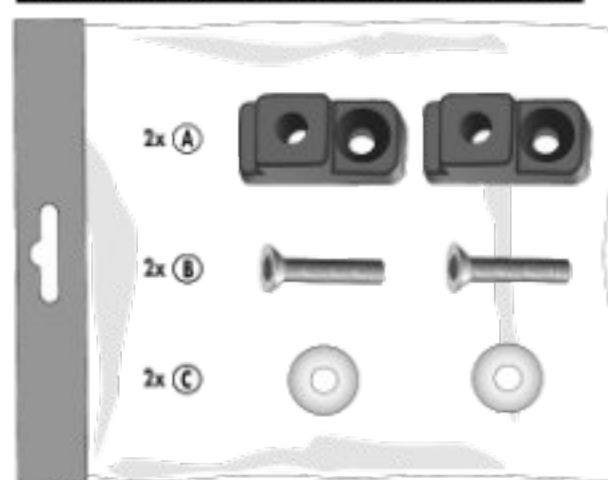

+= Art. # E235

