

PRODUCT INFO

SEAT- PACK QR

Waterproof saddle bag with Seat-Lock mounting system



Compatible with dropper-seatposts with use of an adapter clamp



Compressed

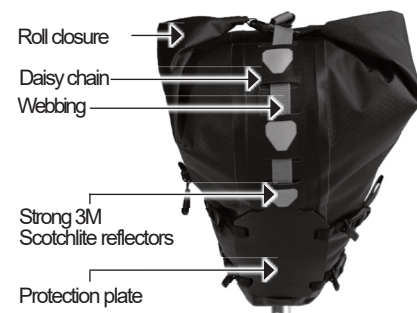

height cm/in	width cm/in.	depth cm/in.	vol. L/cu.in.	weight g/oz.	maximum load kg/ lbs
28/11.0	48/18.9	22/8.7	13/793	625/22.0	3-5/6,6-11,0

SPECIFICATIONS:

- + Waterproof saddlebag with roll closure
- + Seat-Lock mounting system
- + Bag has an internal stiffener and four compression straps; securing the load very well to the saddle and seatpost
- + Compatible with dropper posts when adapter clamp is used (height 4,3cm/1,7in)
- + Ideal for bikepacking, alpcrossing, touring
- + Mounting via levers on the saddle rails and a strong hook and loop fastener around the seatpost
- + Lightweight, robust PU-coated nylon fabric
- + Valve with grip loop to compress the pack volume
- + Elastic cords on the top of the bag for quick stowage of additional gear
- + Protective plate on the bottom prevents damage from tire contact
- + No residual fixing components when the bag is removed
- + Daisy chain for attaching rear light or additional equipment
- + 3M Scotchlite reflectors
- + Maximum load 3 to 5 kg depending on the position of the hooks
- + Requires approx. 3 cm space on the seat post

Contents: Saddlebag with Seat-Lock mounting system, Adapter clamp for dropper posts

Attention: Not suitable for carbon saddles and for mounting on carbon seatposts

Note: In order to meet standard IP64 (6=dustproof, 4=protected against splash water coming from all directions) the closure must be rolled 3-4 times.



SEAT-PACK QR

- DE
- MONTAGEANLEITUNG
- GB
- ASSEMBLY INSTRUCTIONS
- FR
- INSTRUCTIONS DE MONTAGE
- IT
- ISTRUZIONI DI MONTAGGIO
- NL
- MONTAGE HANDLEIDING
- DK
- MONTERINGSVEJLEDNING
- ES
- INSTRUCCIONES DE MONTAJE
- SE
- MONTERINGSANVISNING
- NO
- MONTERINGSANVISNING
- FI
- ASENNUSOHJEET
- PL
- INSTRUKCJA MONTAZU
- JP
- 装着方法

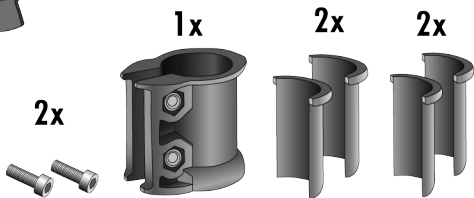
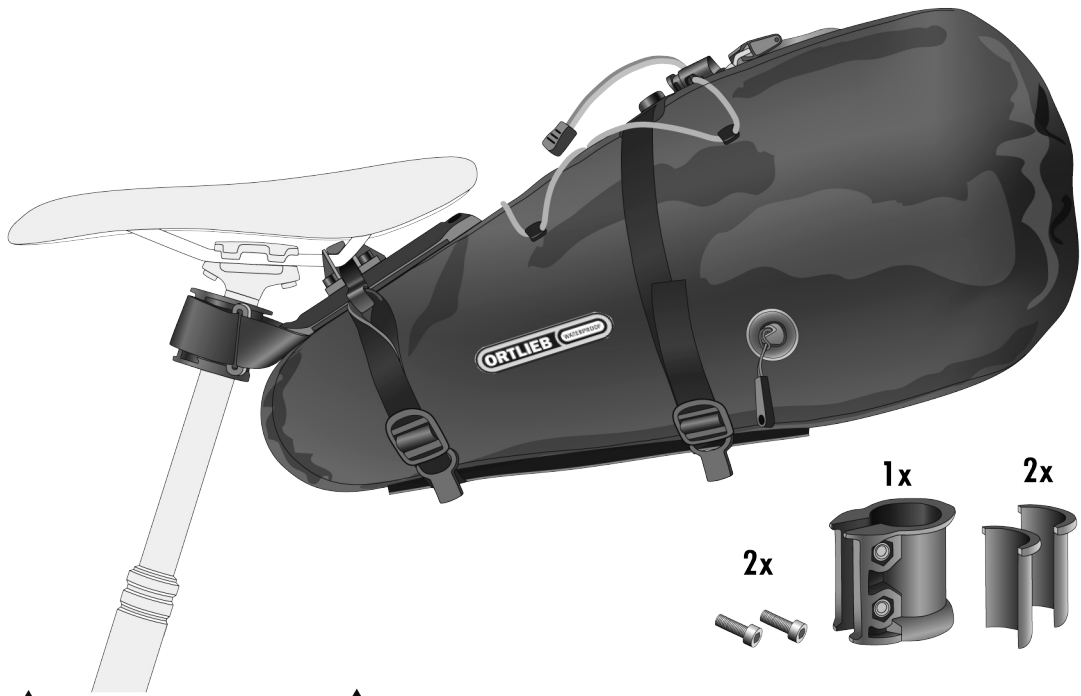

VIDEO

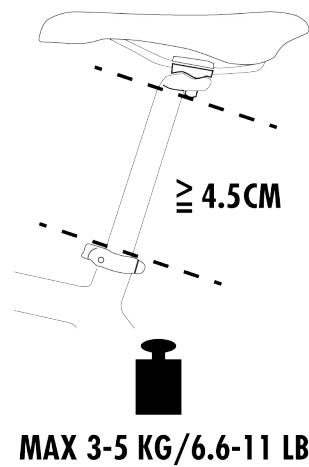

MAX 3-5 KG/6.6-11 LB



NO CARBON

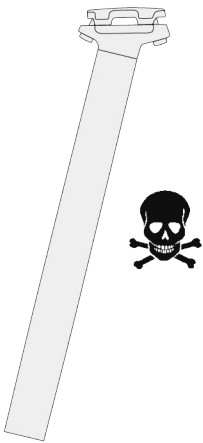

WITHOUT DROPPER POST

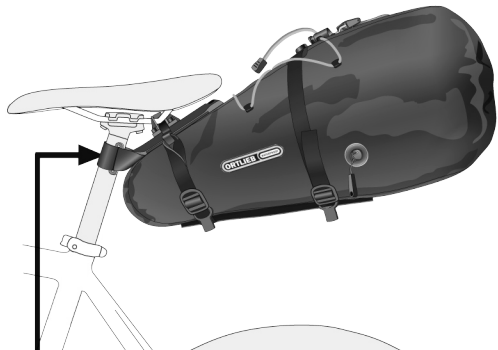

UM KRATZER ZU VERMEIDEN, BENUTZE RAHMEN-SCHUTZFOLIE AN DEN KONTAKTSTELLEN (nicht beinhaltet)
TO AVOID SCRATCHES, USE ADHESIVE FRAME PROTECTION AT CONTACT POINTS (not included)

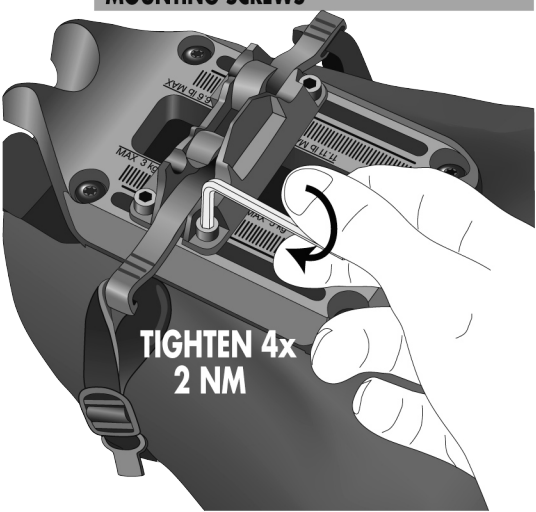
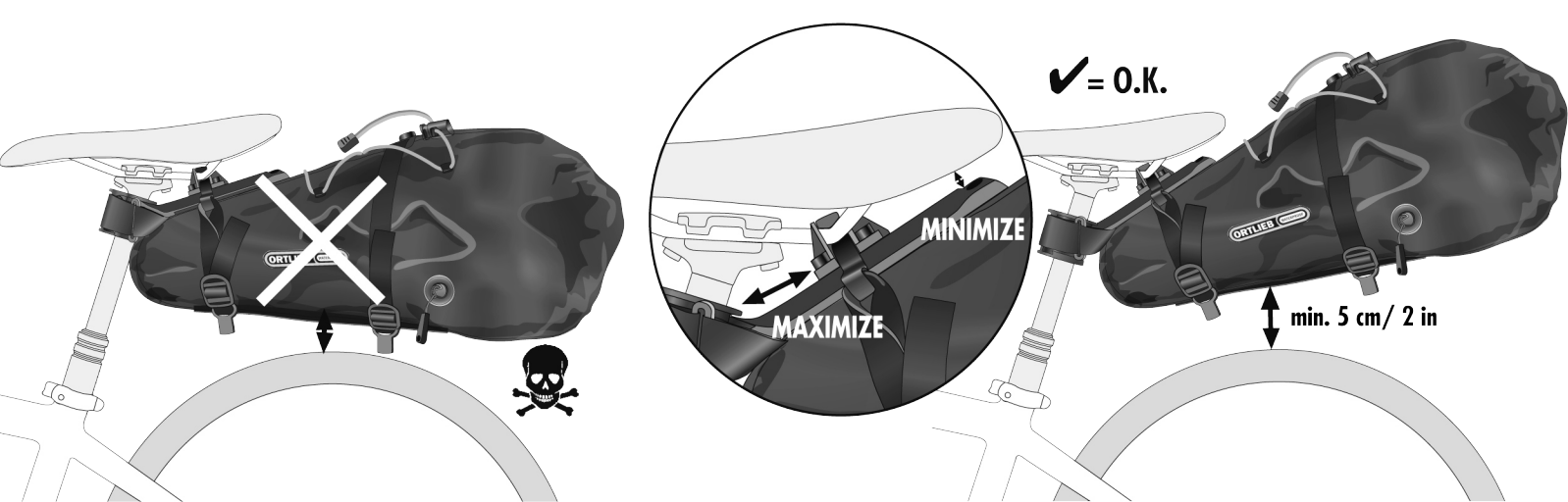
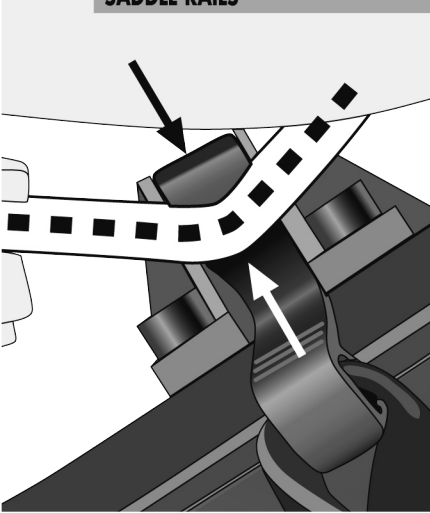
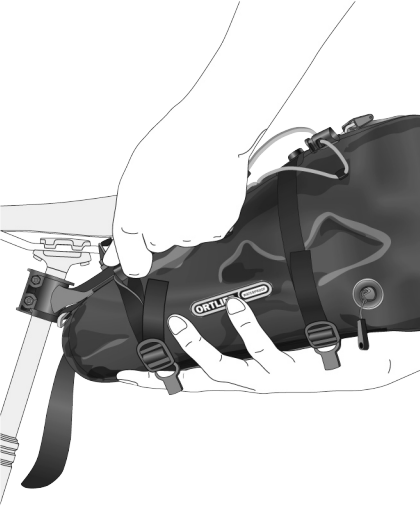
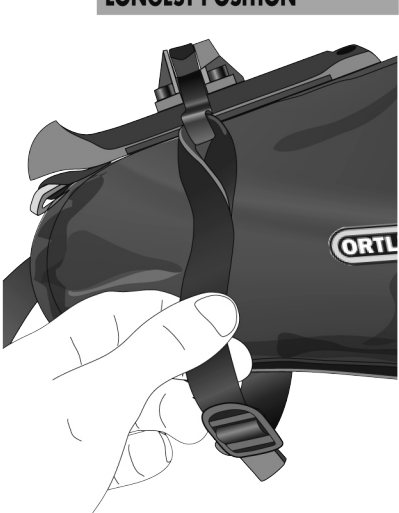
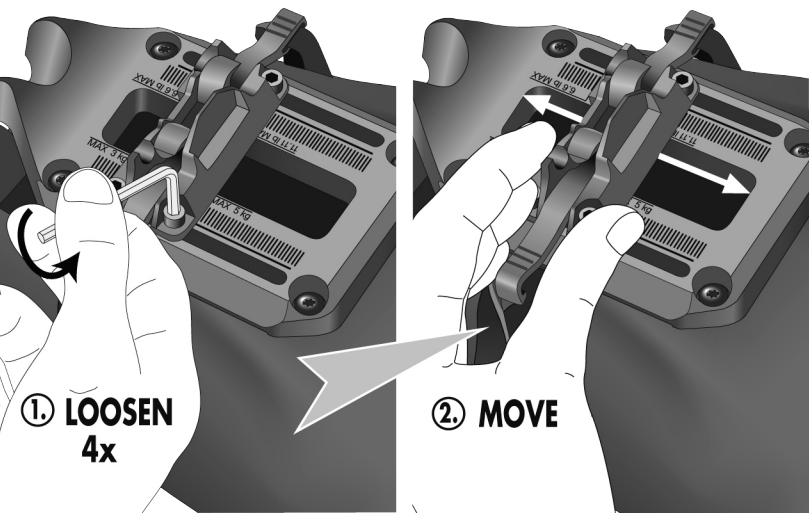
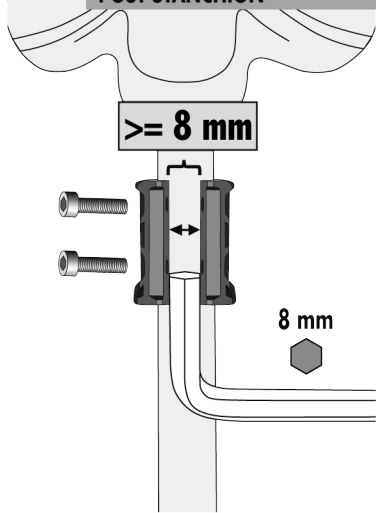
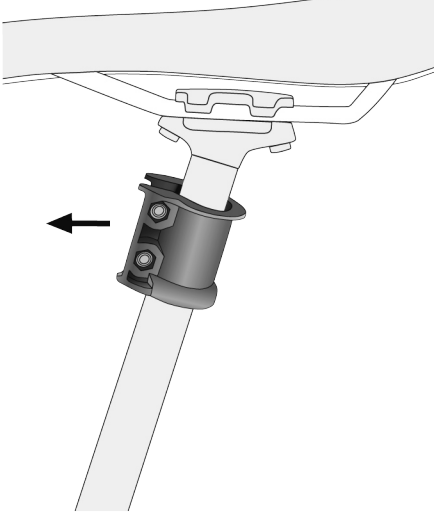
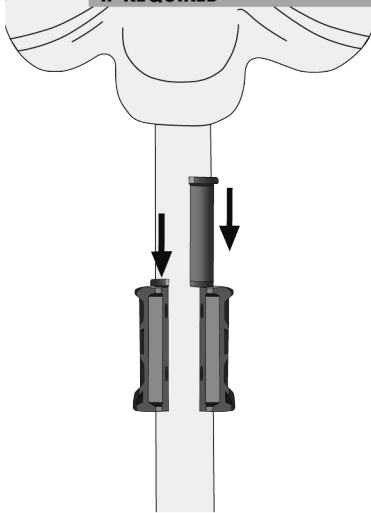
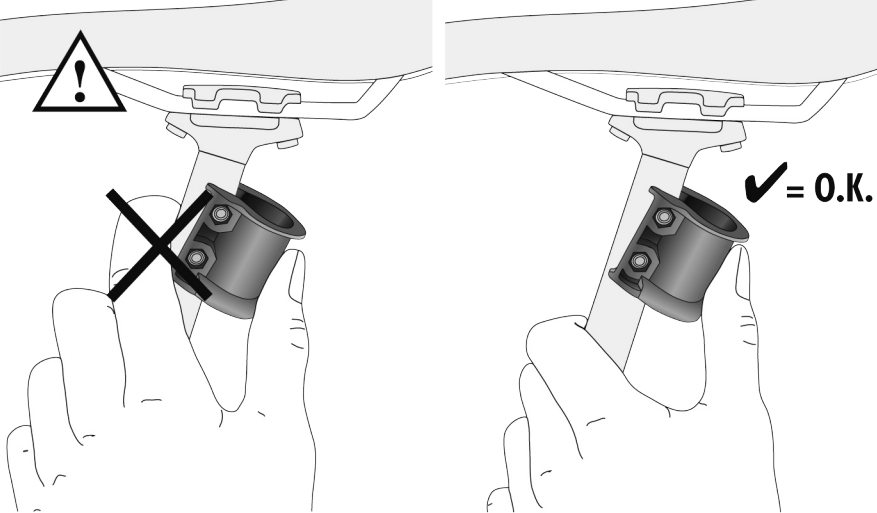
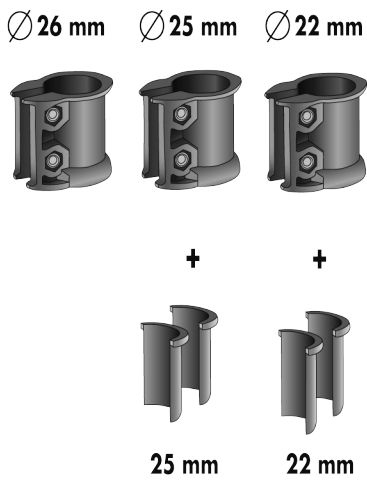
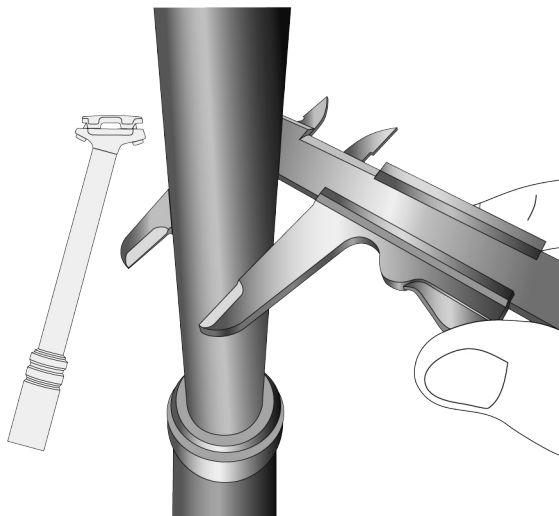
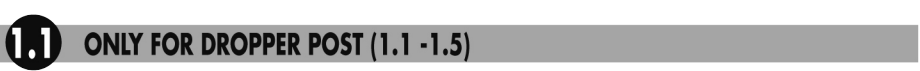

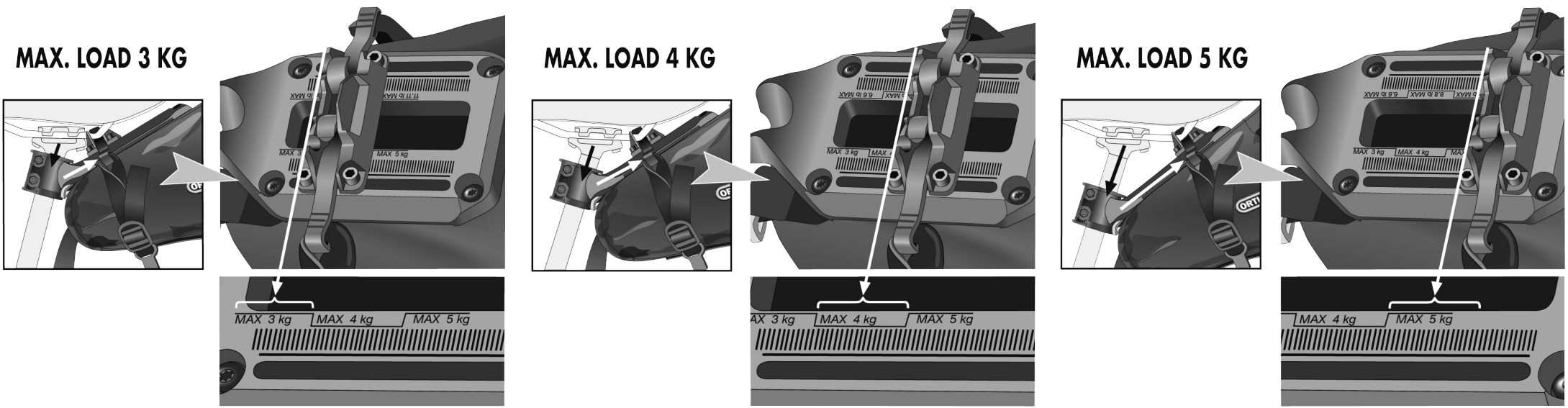

3.0

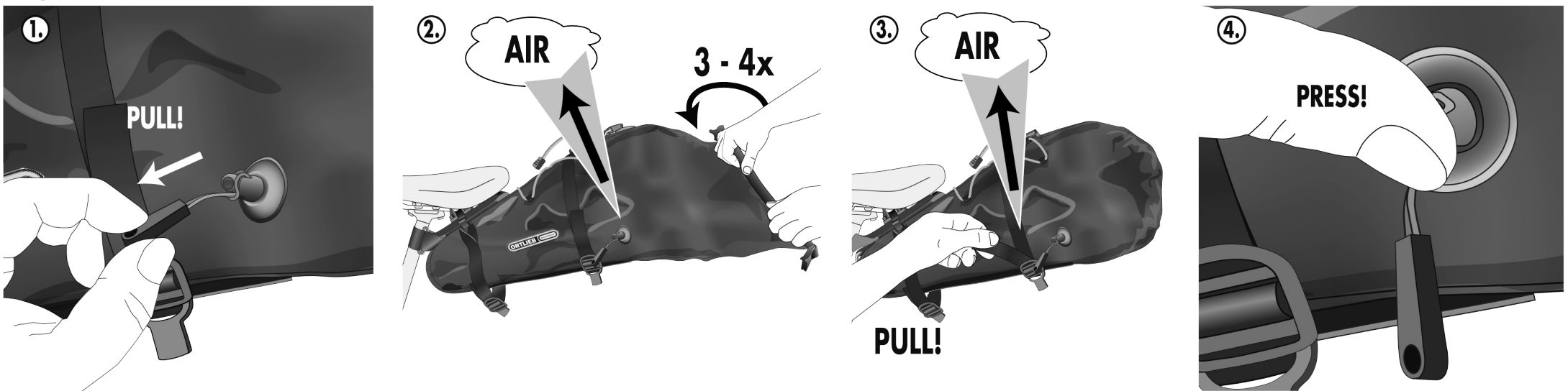

4.0



5.2 TIGHTEN COMPRESSION STRAPS

